

WINDOW/WATER CURTAIN NOZZLE

MODEL CN & CNS



TECHNICAL DATA

MODEL	CN in Brass IS319/ASTM B16 CNS in Stainless Steel construction
MAXIMUM WORKING PRESSURE	12.3 bar (175 psi)
END CONNECTION	1/2" BSPT (NPT Optional)
K- FACTOR METRIC (US)	Km-20, Km-23, Km-32, Km-42, Km-58, Km-79
FINISH	CN - Natural Brass finish, Nickel Chrome plated CNS- Natural finish
WEIGHT (Approx.)	0.180 kg
APPROVAL	UL Listed
ORDERING INFORMATION	Specify: a) Model b) Metric Km-factor c) Finish



DESCRIPTION

Window Curtain Nozzles are non-automatic, open, "outside" sprinklers intended for protection of windows, walls and roofs against exposure fires.

The directional discharge produces a flat fan shaped spray pattern. Used to produce a water curtain, they are installed on manual or automatic deluge systems.

Window Curtain Nozzles are available in Stainless Steel construction with different flow rate.

INSTALLATION

The spray nozzle must be handled with due care. For best results, the storage as well as any further shipment be made in original packing only.

Nozzle which is visibly damaged should not be installed.

Use Teflon tape or soft thread sealant on male thread of the nozzle. The nozzles must be tightened into the fitting.

Excessive tightening torque may result into serious damage to nozzle arms and the deflector which may affect spray pattern of the nozzle and its performance.

Spray nozzles are to be installed in accordance with the latest published standards of NFPA or similar organizations and also with the provisional governmental code, ordinance and standards whenever applicable.

The use of these nozzles may be limited due to occupancy and hazard, refer to Authority having jurisdiction prior to installation.

INSPECTIONS, TESTS & MAINTENANCE

It is recommended that window spray system be inspected regularly by authorised technical personnel. The nozzle must be checked for atmospheric effects, external and internal obstruction, blockage if any. The nozzles should be cleaned or replaced if required. The system must be operated with optimum water flow at least twice in a year or as per the provisions of NFPA or local authority having jurisdiction.

The owner is solely responsible for maintaining the water spray system and the components therein so that it performs properly when required.

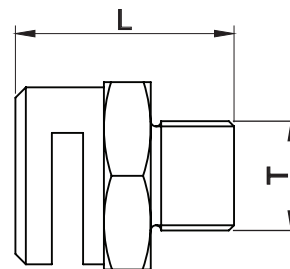

MODEL	T	L In mm
CN	1/2" BSPT	44
CNS	1/2" BSPT	44

DIMENSION in millimeter (Approximate)

WINDOW CURTAIN NOZZLE SPRAY CHARACTERISTICS

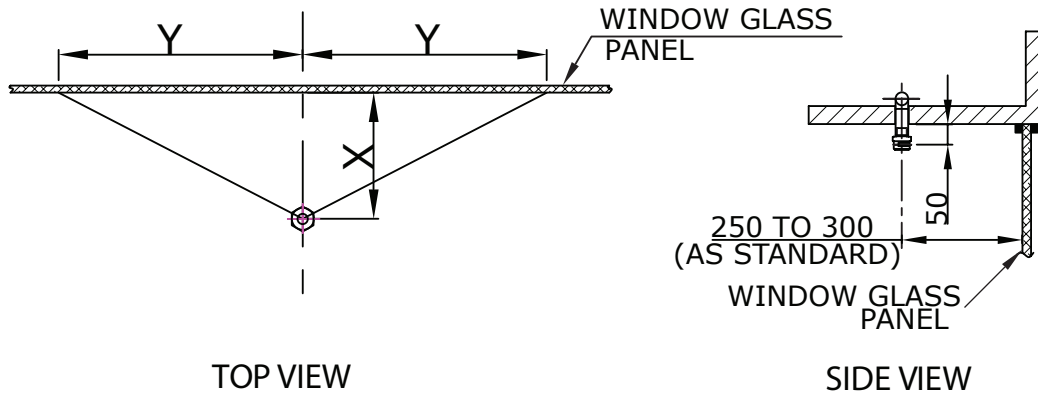

TOP VIEW

SIDE VIEW

Km-20						
X →	250	300	600	900	1200	1500
Pressure (psi)	↓ Y					
7	1050	1350	2400	3300	3900	3900
15	1800	2100	2700	4050	4050	3900
25	3000	3000	2850	4200	4350	3900
30	3000	3000	3000	4200	4350	4050
50	3000	3150	3300	4500	4500	4050
57	3000	3450	3300	4500	4500	4050

Km-23						
X →	250	300	600	900	1200	1500
Pressure (psi)	↓ Y					
7	1050	1350	2400	3300	3900	3900
15	1800	2100	2700	4050	4050	3900
25	3000	3000	2850	4200	4350	3900
30	3000	3000	3000	4200	4350	4050
50	3000	3150	3300	4500	4500	4050
57	3000	3450	3300	4500	4500	4050

Km-32						
X →	250	300	600	900	1200	1500
Pressure (psi)	↓ Y					
7	1200	1800	2550	3750	3600	3600
15	2100	2400	3000	4200	4200	3600
25	3150	2700	3300	4500	4350	3750
30	3300	2850	3600	4650	4500	3750
50	3300	3300	3900	4800	4500	4050
57	3300	3300	3900	4800	4650	4050

Km-42						
X →	250	300	600	900	1200	1500
Pressure (psi)	↓ Y					
7	1650	2250	2550	2775	3750	2550
15	2400	2850	2850	3075	3900	4350
25	3600	3300	3300	3150	4350	4500
30	3600	3900	4200	3300	4350	4500
50	3750	4200	4650	3450	4500	4650
57	3900	4200	4800	3750	4500	4650

Km-58						
X →	250	300	600	900	1200	1500
Pressure (psi)	↓ Y					
7	2100	2250	3150	3450	4050	2700
15	2550	3000	3900	4500	4800	4350
25	3900	4200	4200	4800	5100	4500
30	3900	4650	4500	4800	5100	4650
50	4200	4650	4800	4950	5400	4650
57	4200	4650	4800	5175	5400	4800

Km-79						
X →	250	300	600	900	1200	1500
Pressure (psi)	↓ Y					
7	2550	2550	3450	3600	3450	2850
15	3600	3900	4350	4350	4800	4200
25	3900	4050	4350	4950	4950	4500
30	4200	4500	4650	5250	5250	4500
50	4200	4800	4800	5400	5400	4650
57	4200	4800	4800	5400	5400	4800

All Dimensions in mm

**SPRAY PATTERN - VERTICAL DOWNWARDS
NOZZLE INSTALLATION - HORIZONTAL (SIDEWALL)**

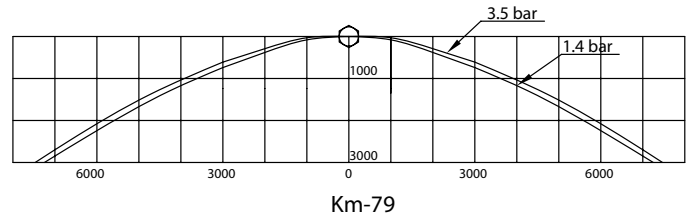
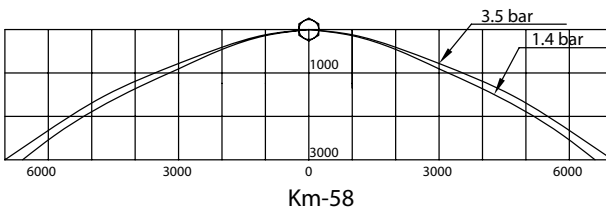
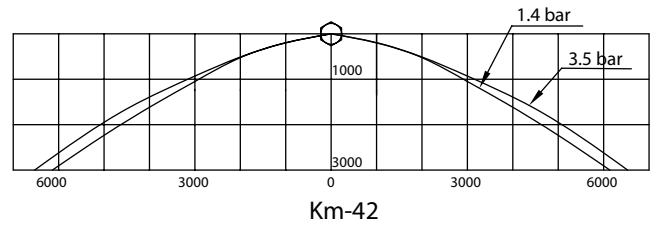
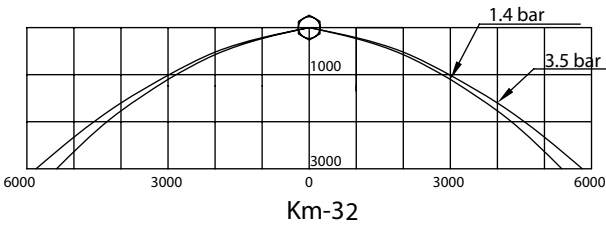
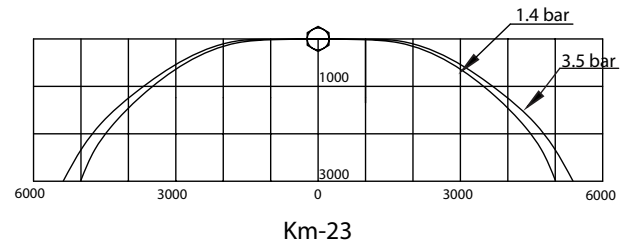
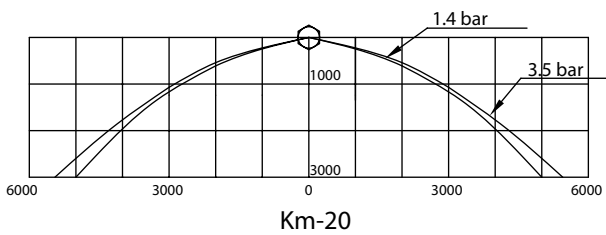
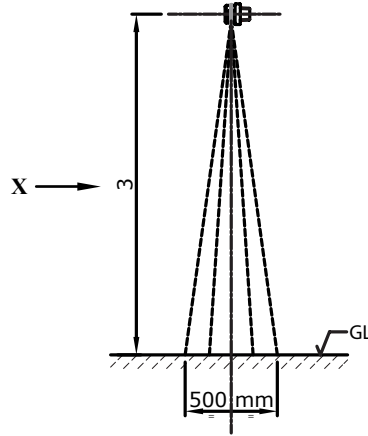

VIEW - 'X'

Scale: Each square is 1000 x 1000 mm

Note:

Spray Pattern profiles are given in the graph for discharge pressure from 1.4 to 4.1 bar. When discharge pressure above this is applied, then the coverage area will decrease because spray pattern tends to draw inward at higher pressure. For pressure above 4.1 bar, consult HD FIRE Technical Service. Design data obtained from tests in still air.

Km is metric K-factor and marked on nozzle.

LIMITED WARRANTY

HD FIRE PROTECT PVT. LTD. hereby referred to as HD FIRE warrants to the original purchaser of the fire protection products manufactured by HD FIRE and to any other person to whom such equipment is transferred, that such products will be free from defect in material and workmanship under normal use and care, for two (2) years from the date of shipment by HD FIRE. Products or Components supplied or used by HD FIRE, but manufactured by others, are warranted only to the extent of the manufacturer's warranty. No warranty is given for product or components which have been subject to misuse, improper installation, corrosion, unauthorized repair, alteration or un-maintained. HD FIRE shall not be responsible for system design errors or improper installation or inaccurate or incomplete information supplied by buyer or buyer's representatives. HD FIRE will repair or replace defective material free of charge, which is returned to our factory, transportation charge prepaid, provided after our inspection the material is found to have been defective at the time of initial shipment from our works. HD FIRE shall not be liable for any incidental or consequential loss, damage or expense arising directly or indirectly from the use of the product including damages for injury to person, damages to property and penalties resulting from any products and components manufactured by HD FIRE. HD FIRE shall not be liable for any damages or labour charges or expense in making repair or adjustment to the product. HD FIRE shall not be liable for any damages or charges sustained in the adaptation or use of its engineering data & services. In no event shall HD Fire's product liability exceed an amount equal to the sale price. The foregoing warranty is exclusive and in lieu of all other warranties and representation whether expressed, implied, oral or written, including but not limited to, any implied warranties or merchantability or fitness for a particular purpose. All such other warranties and representations are hereby cancelled.

NOTICE :

The equipment presented in this bulletin is to be installed in accordance with the latest publication standards of NFPA or other similar organisations and also with the provision of government codes or ordinances wherever applicable.

The information provided by us is to the best of our knowledge and belief, and consist of general guidelines only. Site handling and installation control is not in our scope. Hence we give no guarantee for result and take no liability for damages, loss or penalties whatsoever, resulting from our suggestion, information, recommendation or damages due to our product.

Product development is a continuous programme of HD FIRE PROTECT PVT. LTD. and hence the right to modify any specification without prior notice is reserved with the company.



HD FIRE PROTECT PVT. LTD.
Protecting What Matters Most to You

D-6/2, ROAD NO. 34, WAGLE INDUSTRIAL ESTATE, THANE 400 604, INDIA.
• TEL: + (91) 22 2158 2600 • FAX: +(91) 22 2158 2602
• EMAIL: info@hdfire.com • WEB: www.hdfire.com